

Ridgeline

**Flexible stainless
steel tubing for
all plumbing
installations**



Ridgeline

UNLEARN ELBOWS.

What elbows?

Flexible stainless steel
piping for **hot and cold**
water systems



Ridgeline™ is a fast, truly versatile and cost-effective system for all water installations.

Built on decades of manufacturing expertise, Ridgeline delivers superior performance that sets new standards in UK plumbing. Our innovative system combines speed, reliability, and sustainability.

Transform your installations with:

- Up to 3x faster installation
- Significantly fewer potential leak points
- Industry-leading sustainability
- Universal compatibility

Choose Ridgeline for quicker installs, fewer potential leak points, and a sustainable future.



Key Benefits at a Glance

Faster Installation with Confidence

Install Ridgeline™ up to 3x faster than PEX, with our guaranteed kink-resistant design. The exceptional flexibility allows you to create bends tighter than 90 degrees with minimal effort, ensuring fast, confident installations every time.

Smart Economics

Ridgeline™ delivers premium performance while reducing total system costs. By eliminating the need for most fittings, dramatically cutting installation time, and removing potential leak points, Ridgeline™ provides exceptional value compared to both PEX and copper systems. Each fitting removed saves not just on material costs, but also on labour time and future maintenance risk.

Universal Compatibility

Ridgeline™ fittings seamlessly integrate with standard EN1254 compression fitting bodies and nuts through our patent-pending RidgeLock™ sealing technology. By simply replacing the traditional olive with our engineered sealing ring, you transform standard compression fittings into superior mechanical connections. This universal compatibility means installers can source fittings through existing merchant supply chains with no need for special parts or tools.

Reduce Potential Leak Points from Behind the Wall

Ridgeline allows for long continuous runs without the need for joints, fittings, or elbows in concealed or hard-to-reach areas. This feature eliminates potential leak points, providing greater reliability and peace of mind during and after installation.



Key Benefits at a Glance

Sustainably Manufactured

Ridgeline™ sets new environmental standards with a minimum of 80% recycled marine-grade stainless steel. Our commitment to sustainability extends from materials to manufacturing, creating a truly forward-thinking solution.

Stainless Steel for Cleaner Water

Ridgeline's stainless steel construction ensures exceptional water quality with water exposure to plastic being eliminated.

Low Carbon Footprint

During the manufacturing process, Ridgeline tubing has significantly lower embodied carbon per metre compared to copper or PEX, reducing the environmental impact of plumbing installations.

No Hot Works

Eliminate fire risks, reduce downtime and simplify compliance.





What is Flexible Steel Piping?

Ridgeline™ is made from stainless steel sheet, shaped into corrugations that bends effortlessly by hand while retaining the strength and durability of rigid steel or copper. This design provides the strength of rigid copper with significantly less material per metre, making it efficient and practical.



The corrugations allow for flexibility without sacrificing on strength, compressing together on the inside edge and slightly expanding on the outside edge to easily create any angle required.

Research from Lancaster University confirms that Ridgeline™ offers superior corrosion resistance compared to copper in UK drinking water conditions. This enhanced resistance leads to a longer lifespan and reduced risk of leaks or failures.

School of Engineering



Point-to-Point Plumbing Perfected

Speed Through Complexity

Route Ridgeline™ through the most challenging spaces with ease. Even our largest diameter tubes thread through tight spaces as effortlessly as electrical cable, transforming complex installations into simple point-to-point runs.

Time-Saving Technology

Eliminate time-consuming workarounds and complex fitting arrangements. Ridgeline's exceptional flexibility means you can create direct routes from source to outlet, significantly reducing installation time and complexity.

See It In Action

Scan the QR code to watch our installation race videos and discover just how fast Ridgeline™ can be installed compared to traditional systems.





Impossible to Kink Engineered for Confidence

Unmatched Flexibility

Ridgeline's corrugated design delivers exceptional flexibility while being completely kink-proof. This unique combination lets installers work faster and with total confidence, even in the most challenging spaces.

Maximum Efficiency

Available in lengths up to 500m, Ridgeline's lightweight yet robust construction revolutionises on-site handling. Cut exact lengths from the spool, eliminate wastage, and create long, continuous runs without joints.

Superior By Design

While traditional systems risk kinking under pressure, Ridgeline's engineered corrugations ensure consistent performance in every installation. No kinks means no delays, no waste, and no callbacks.

Lightweight & Metre-Marked for Efficiency

Ridgeline™ is ultra-lightweight, making it easy to handle and move around site. With precise metre markings along its length, measuring and cutting is faster and more accurate—saving time and reducing waste.

Eliminate fittings from behind the wall



Did you know?

UK homes are potentially wasting £697 million annually on water bills due to leaks, amounting to approximately 900 million litres of clean drinking water lost every day. Insurers pay out around £657 million each year for water damage in homes.

Ridgeline's complete flexibility, combined with its kink-resistant design, allows 90-degree bends (or tighter) to be made quickly and effortlessly by hand, staying in place to enable easy routing through interior spaces and around obstacles with long continuous runs. By eliminating the need for elbows, Ridgeline offers faster installations, cost savings, and a significantly reduced risk of leaks due to fewer potential leak points.

Which would you rather
drink from every day?



Stainless steel is the go-to option when
hygienic, clean water is needed most.

No leaching of chemicals or VOC's. No
shedding of micro and nano plastics.

Just clean water.

Ridgeline

100% 316L stainless steel





Two Connection Systems:

RidgeLock™ (R-15mm, R-22mm, R-28mm): Connect to any EN 1254 fitting. Replace the olive with our sealing ring on the Ridgeline side. Fast, familiar, universally available and economical.

*Patent Pending

P1 Mechanical (R-15mm to R-54mm): Complete assemblies across the full range. Metal-on-metal seal with secondary elastomer. Available where RidgeLock isn't offered, or preferred for large installations requiring system consistency.

*Patent: 20107131

RidgeLock™: Patent-pending compatibility with any EN 1254 compression fitting

Ridgeline™ is designed to work seamlessly with standard EN 1254 fittings, maximising compatibility and simplifying the supply chain for both installers and merchants. By utilising standard EN 1254 fitting bodies and nuts, Ridgeline maintains full compatibility with widely available copper compression fittings, ensuring that no specialised parts are required.





The Key Innovation: RidgeLock™ Sealing Ring

Traditional olives rely on compression alone and can fail under pipe movement. The RidgeLock™ sealing ring takes a fundamentally different approach, using engineered teeth that mechanically interlock with Ridgeline™'s corrugations.

This positive mechanical connection maintains its integrity even under bending forces, creating a robust, reliable seal that's ideal for concealed installations where long-term reliability is essential.

RidgeLock™ - Key Benefits

For Installers:

Ridgeline fittings are engineered for simplicity and reliability. With RidgeLock™, simply replace the traditional olive in an EN1254 copper compression fitting with our sealing ring to convert it into a RidgeLock fitting. This straightforward adaptation allows you to work with components readily available on-site, reducing the time spent sourcing specific parts. The RidgeLock's positive mechanical lock ensures a secure, leak-free connection, providing confidence even in concealed installations.

For Merchants:

Ridgeline fittings offer a practical way to enhance your existing inventory without over-complicating stock management. By adding RidgeLock™ sealing rings to your EN1254 fittings, you can provide a premium, upgraded fitting solution without the need to introduce a new product line. RidgeLock's compatibility with EN1254 fitting bodies means that merchants can easily provide a superior solution to installers, ensuring consistent availability and supporting a simplified supply chain.



RidgeLock™ FAQ

How do RidgeLock™ fittings work?

RidgeLock™ creates a positive mechanical lock by combining standard EN1254 fitting components with our engineered sealing ring. The sealing ring's teeth mechanically interlock with the tube's corrugations, creating a robust, reliable seal that maintains its integrity even when subjected to bending forces.

Is a RidgeLock™ fitting a copper compression fitting?

No. While RidgeLock™ fittings utilise the nut and body from EN1254 fittings, the similarity ends there. Once the copper olive is replaced with our RidgeLock™ sealing ring, it becomes a fundamentally different connection system utilising a mechanical interlock rather than compression.

What tube sizes is RidgeLock™ compatible with?

Ridgeline sealing rings are compatible with R-15mm, R-22mm and R-28mm pipe sizes.

Why use RidgeLock™ on small sizes?

Universal EN 1254 compatibility delivers significant practical advantages:

- Fittings available from any merchant
- Easy emergency repairs using existing stock
- Simple integration with existing copper systems
- Familiar installation process for all installers
- Simplified supply chain management
- Highly economical, due to low price of EN 1254 fittings

Can RidgeLock™ fittings be placed in concealed spaces?

Like all plumbing fittings, installation should follow Water Regulations guidance regarding concealed locations. While RidgeLock's™ positive mechanical lock provides additional security, best practice remains to minimise concealed fittings where possible through good system design. Ridgeline's flexibility often helps eliminate the need for concealed fittings entirely.

Can I use both RidgeLock and P1 on the same installation?

Yes both systems can be used on the same plumbing system.



P1 Mechanical Fittings

P1 creates a robust connection through a metal-on-metal seal at the fitting seat, supported by a secondary elastomer. Fittings are supplied as complete assemblies in sealed bags.

Key Features:

- Available across full size range (R-15mm to R-54mm)
- Metal-on-metal primary seal with elastomer backup
- Assembly with two spanners—no specialist tools
- Rated to 15 bar (UK mains pressure rarely exceeds 3-5 bar)

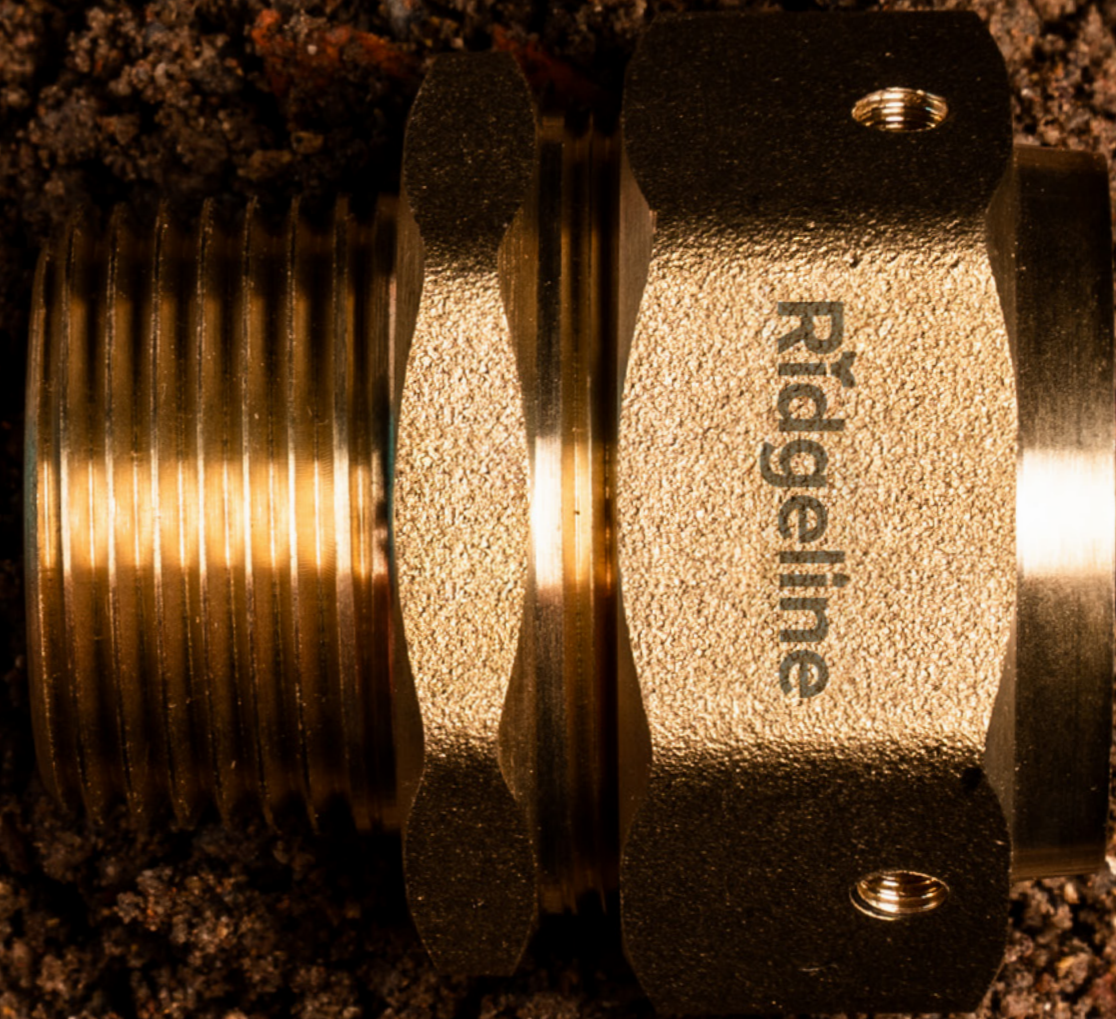



P1 Mechanical Fittings FAQ

What's the difference between RidgeLock™ and P1 connection systems?

Both create reliable, robust connections. RidgeLock adapts to standard EN 1254 copper compression fittings (universal availability), whilst P1 provides complete fitting assemblies. On R-15, R-22 and R-28 pipe sizes both systems are available and fully interchangeable. On larger sizes up to R-54mm, P1 Mechanical is the connection system.

When should I specify P1 on small sizes?

Choose P1 when:

- Projects with single-manufacturer requirements
- Your installation includes large sizes (R35+) and you want one connection system throughout
- Working pressure requirements exceed 10 bar

What tools are required for P1 installation?

Two spanners, and a Ridgeline tube cutter. No further specialist tools needed.

Can RidgeLock™ P1 fittings be disassembled after installation?

Yes. P1 fittings can be disassembled if required.

Can RidgeLock™ fittings be placed in concealed spaces?

All fitting types can be placed in concealed spaces following Water Regulations guidance.

1/6 carbon footprint of copper

1/2 carbon footprint of PEX

Made from 80%+ recycled 316L stainless steel

Ridgeline™ tube is manufactured using a target of 80% recycled marine-grade 316L stainless steel. We are continually increasing % recycled content as part of our commitment to sustainability.



A focus on sustainability:

The Ridgeline carbon story:



Ridgeline™ is made from a target 80% recycled stainless steel.

The recycled material is formed into new stainless steel strip using a state of the art arcing furnace which is a low carbon method of manufacturing stainless steel.



The stainless steel strip is then manufactured into our Ridgeline™ tube at our facility which relies heavily on solar power.

Shipping is generally a low carbon activity however, as Ridgeline™ is so lightweight, over 70,000m can be loaded in just one container making it even more efficient.



Ridgeline™ packaged in the using renewable materials like wooden spools and cardboard boxes. We attempt to reduce plastic usage to an absolute minimum.



Ridgeline™ uses significantly less material per m vs. copper or PEX. This contributes significantly to reducing our carbon footprint per metre.

At the end of life stage, Ridgeline™ is 100% fully recyclable, which is not possible with PEX tubing.



Ridgeline™ greenhouse gas emissions (GHG) are currently being audited and certified by Ernst and Young.

Less material per metre of tube

=

Less greenhouse gas emissions

It's a simple formula!

The manufacture of Ridgeline yields less emissions of CO₂e compared to PEX and Copper (per tonne of manufactured goods), however due to the reduced amount of material needed per metre, the CO₂ savings are significantly multiplied.

Size	Product	mt CO ₂ e per tonne manufactured	Weight per metre of tube
15mm	Ridgeline™	2.20 - 2.50 mt CO ₂ e	96 g
	PEX	2.10 - 3.00 mt CO ₂ e	100 g
	Copper Tube	3.50 - 5.00 mt CO ₂ e	266 g
22mm	Ridgeline™	2.20 - 2.50 mt CO ₂ e	144 g
	PEX	2.10 - 3.00 mt CO ₂ e	160 g
	Copper Tube	3.50 - 5.00 mt CO ₂ e	505 g
28mm	Ridgeline™	2.20 - 2.50 mt CO ₂ e	240 g
	PEX	2.10 - 3.00 mt CO ₂ e	260 g
	Copper Tube	3.50 - 5.00 mt CO ₂ e	900 g

*CO₂ per kg of copper is sourced from published data from the Copper Development Association (copper.org). Weights are estimates, and will vary by manufacturer.

*CO₂ per kg of PEX is an estimate sourced from averages across a number of EPD's (Environmental Product Declaration) of PEX manufacturers. Numbers will vary by manufacturer. Weights are also estimates, and will vary by manufacturer.

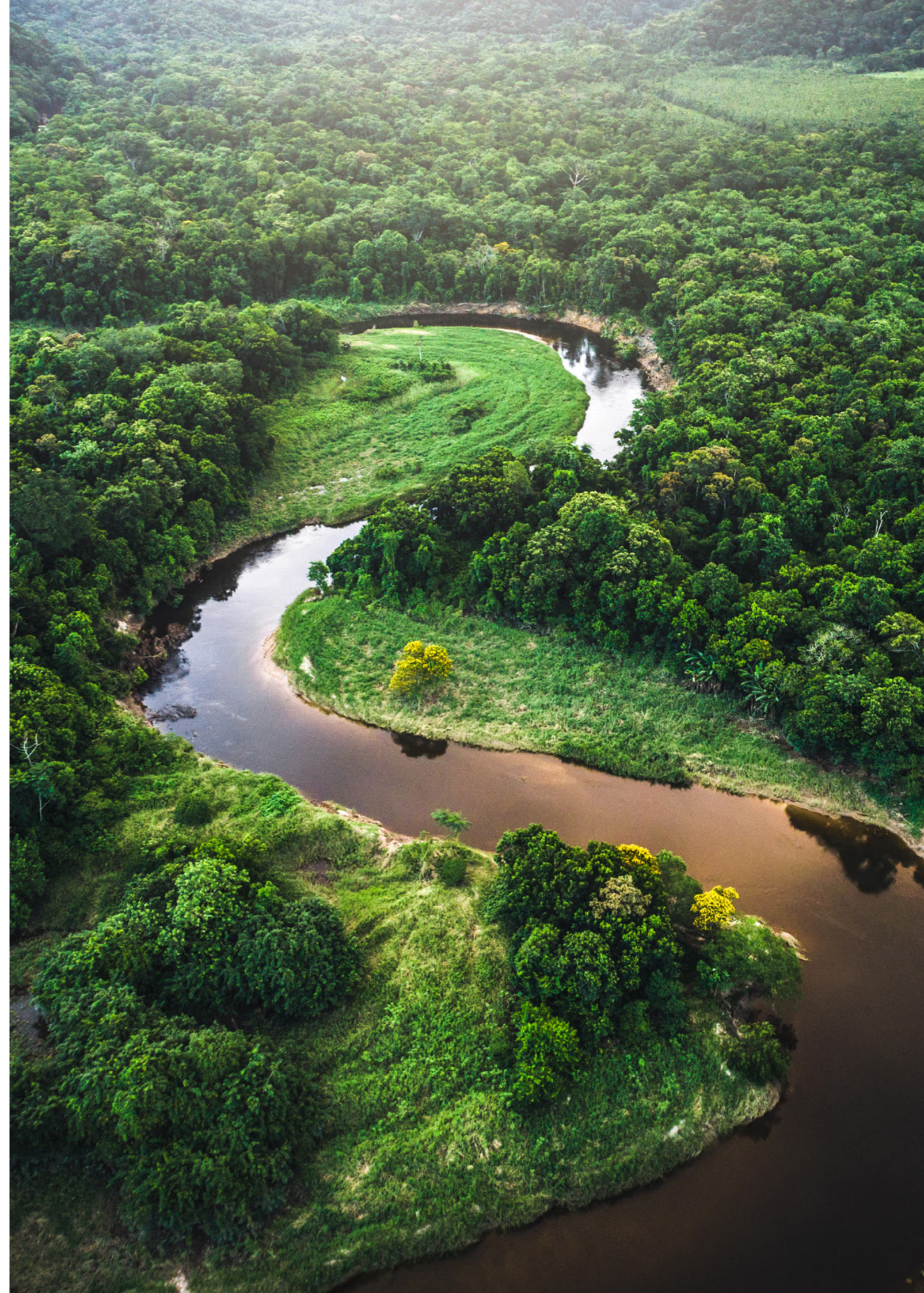



System Cost Analysis

Whilst Ridgeline's premium materials command a higher per-metre, that's not the full story:

Each fitting adds to your installation:

- Material cost
- Labour time to install
- 2x potential leak points on each side (if an elbow or union)
- Future maintenance risk

Ridgeline's flexibility eliminates fittings:

- Long continuous runs
- No elbows needed
- Faster installation time
- Fewer potential leak points

We have tools and worksheets available to help calculate the true installation costs for your project.

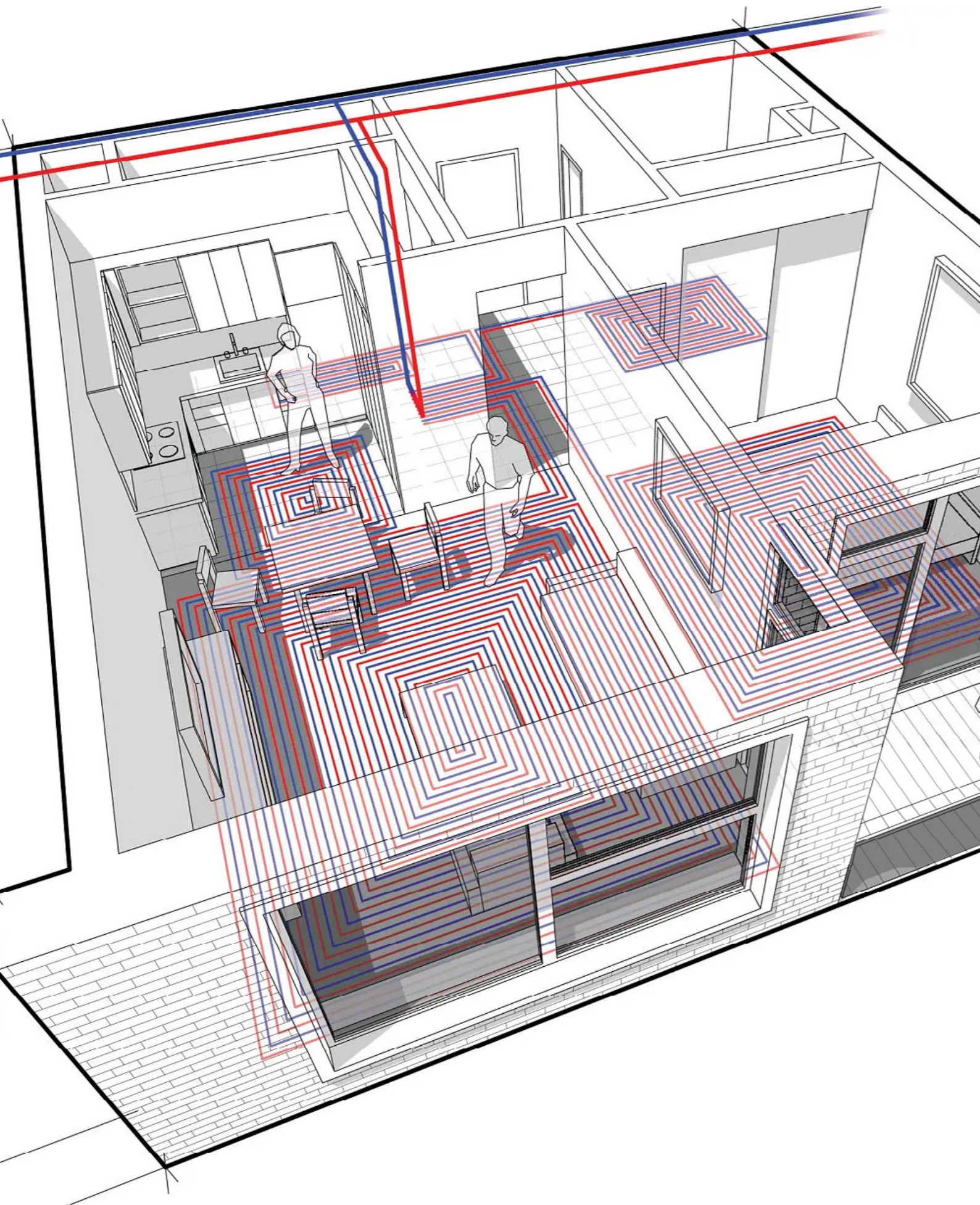

We are here to help:

We are committed to supporting you every step of the way, from initial design to installation. Whether you need expert guidance or want to take control yourself, we've got you covered.

Design services

Send us your drawings for a complete plumbing system design including:

- Flow rate calculations
- Pressure loss analysis
- Optimal pipe sizing
- Detailed bill of materials

Software and Training

Access our design software and receive training to:

- Design efficient point-to-point systems
- Calculate pressure losses
- Plan manifold installations
- Optimise system layout

Site visits

Arrange a site visit from one of our experienced representatives to ensure everything goes smoothly on-site. We're here to help you get the best results.

How to install RidgeLock™ fittings:

Step 1 Choose

Buy ANY EN1254-2 compression fitting from your local merchant. Compression fittings for copper tube are widely available in the UK, and Ridgeline tube is compatible with all compression fittings by replacing the olive with a RidgeLock™ sealing ring.



Step 2 Take out

Open up the fitting and take out the copper olive. Recycle it (or keep for use with copper tube).



Step 3 Replace

Replace the copper compression olive with a RidgeLock™ sealing ring. You now have a complete RidgeLock™ fitting.

Remember: this fitting now has a positive interlocking seal, and is far superior to a standard copper compression olive.



Step 4 Cut

Cut the Ridgeline tubing with a metal wheel pipe cutter.



Step 5 Remove

With a utility knife, safely remove the outer protective cover so that the last 6-7 corrugations are exposed.



Step 6 Slide

Slide the nut onto the tubing.



Step 7 Assemble

Assemble the RidgeLock™ sealing ring over the end of the tube, such that the metal teeth abut, but does not cover the end of the plastic cover, and such that the rubber tongue extends into the 3rd corrugation valley, and leave 3 corrugation peaks in front of the adapter, and to be inserted into the



Step 8 Tighten

Tighten the nut onto the fitting body. Only a few half turns of the nut are required to obtain a seal.



How to Install P1 Mechanical Fittings:

Step 1 Cut

Use a wheel metal pipe cutter, centring in the valley between corrugations.



Step 2 Expose

Remove the clear cover to reveal four corrugations.



Step 3 Slide

Position nut and collars over the tubing. Make sure the split collars are assembled around the tube so that only one corrugation peak is in front of the split collars.



Step 4 Tighten

Use two wrenches to secure; last corrugation deforms for the seal.



Step 5 Sleeve

Optional Step: If lagging or sleeving is required, apply your chosen insulation.



Step 6 Bond

Optional Step: If earth bonding of your installation is required, you can bond directly to any P1 fitting using a P1-Bond kit.

Attach the earthing clamp and warning label before screwing down onto the earthing cable.



Ridgeline™ Tube



Description	Code
15mm - 25m (box)	R-15-25
15mm - 50m (box)	R-15-50
15mm - 75m (box)	R-15-75
15mm - 100m (box)	R-15-100
15mm - 500m (spool)	R-15-500
22mm - 25m (box)	R-22-25
22mm - 50m (box)	R-22-50
22mm - 75m (box)	R-22-75
22mm - 100m (box)	R-22-100
22mm - 250m (spool)	R-22-250
28mm - 25m (box)	R-28-25
28mm - 50m (box)	R-28-50
28mm - 75m (spool)	R-28-75
28mm - 100m (spool)	R-28-100
28mm - 250m (spool)	R-28-250
35mm - 25m (box)	R-35-25
35mm - 50m (spool)	R-35-50
35mm - 75m (spool)	R-35-75
35mm - 100m (spool)	R-35-100
35mm - 400m (spool)	R-35-400
42mm - 25m (box)	R-42-25
42mm - 50m (spool)	R-42-50
42mm - 75m (spool)	R-42-75
42mm - 100m (spool)	R-42-100
42mm - 200m (spool)	R-42-200
54mm - 25m (box)	R-54-25
54mm - 50m (spool)	R-54-50
54mm - 75m (spool)	R-54-75
54mm - 100m (spool)	R-54-100
54mm - 150m (spool)	R-54-150

RidgeLock™ Sealing Rings



Description	Code
10 x 15mm Adapters (bag)	O-15-10
10 x 22mm Adapters (bag)	O-22-10
10 x 28mm Adapters (bag)	O-28-10
100 x 15mm Adapters (bag)	O-15-100
100 x 22mm Adapters (bag)	O-22-100
100 x 28mm Adapters (bag)	O-28-100

Accessories

Description	Code
Tube Cutter (15-28mm)	TC-01
Tube Cutter (35-42mm)	TC-02
Spool Rolling Kit	R-SPL-L

Reminder: How to price and code Ridgeline™ fittings

Ridgeline fittings are designed to be compatible with ANY compression fitting. Therefore, you purchase and price them the same way you would your existing compressing fitting range:

- Utilise any EN1254 compression fitting:

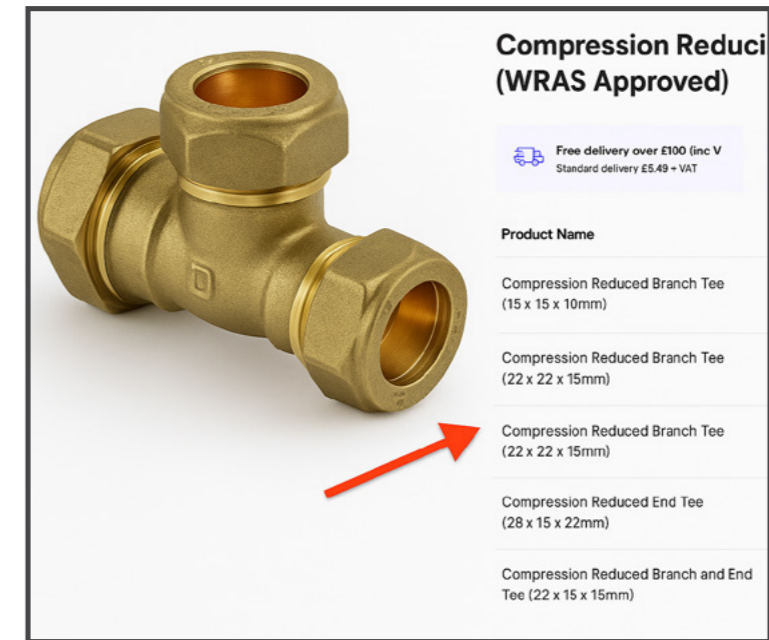

- Replace the copper olives, with Ridgeline sealing rings:



- You now have a fitting ready for Ridgeline tube:

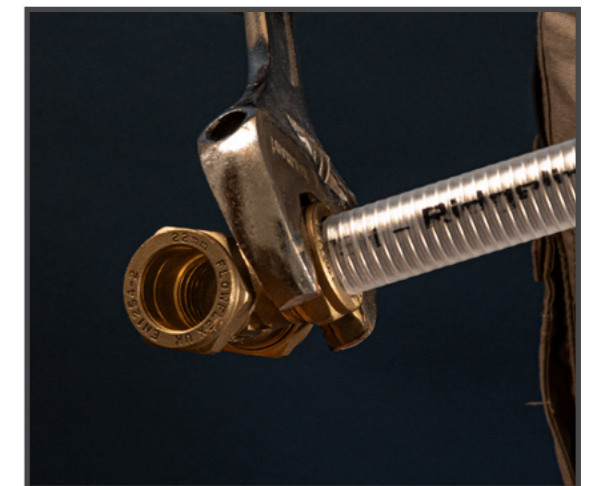

P1: MALE



Description	Code
R-15mm x 1/2" Male BSP	P1-SM-15-12
R-22mm x 3/4" Male BSP	P1-SM-22-34
R-28mm x 1" Male BSP	P1-SM-28-10
R-35mm x 1 1/4" Male BSP	P1-SM-35-114
R-42mm x 1 1/2" Male BSP	P1-SM-42-112
R-54mm x 2" Male BSP	P1-SM-50-20

P1: FEMALE



Description	Code
R-15mm x 1/2" Female BSP	P1-SF-15-12
R-22mm x 3/4" Female BSP	P1-SF-22-34
R-28mm x 1" Female BSP	P1-SF-28-10
R-35mm x 1 1/4" Female BSP	P1-SF-35-114
R-42mm x 2" Female BSP	P1-SF-42-20
R-54mm x 2" Female BSP	P1-SF-50-20

P1: UNIONS



Description	Code
R-15mm x R-15mm	P1-SU-15
R-22mm x R-22mm	P1-SU-22
R-28mm x R-28mm	P1-SU-28
R-35mm x R-35mm	P1-SU-35
R-42mm x R-42mm	P1-SU-42
R-54mm x R-54mm	P1-SU-54

P1: REDUCING UNION



Description	Code
R-22mm x R-15mm	P1-SR-22-15
R-28mm x R-15mm	P1-SR-28-15
R-28mm x R-22mm	P1-SR-28-22
R-35mm x R-28mm	P1-SR-35-28
R-42mm x R-28mm	P1-SR-42-28
R-42mm x R-35mm	P1-SR-42-35
R-54mm x R-42mm	P1-SR-54-42

P1: FEMALE ELBOWS



Description	Code
R-35mm x 1 & 1/2" Female BSP	P1-EF-35-112
R-42mm x 2" Female BSP	P1-EF-42-20
R-54mm x 2" Female BSP	P1-EF-54-20

P1: COPPER TO FG UNION



Description	Code
R-15mm to 15mm Copper	P1-CC-15-15
R-22mm to 22mm Copper	P1-CC-22-22
R-28mm to 28mm Copper	P1-CC-28-28
R-35mm to 35mm Copper	P1-CC-35-35
R-35mm to 28mm Copper	P1-CC-35-28
R-42mm to 42mm Copper	P1-CC-42-42
R-54mm to 54mm Copper	P1-CC-54-54
R-54mm to 42mm Copper	P1-CC-54-42

P1: EQUAL TEES



Description	Code
R-15mm Equal Tee	P1-TT-15
R-22mm Equal Tee	P1-TT-22
R-28mm Equal Tee	P1-TT-28
R-35mm Equal Tee	P1-TT-35
R-42mm Equal Tee	P1-TT-42
R-54mm Equal Tee	P1-TT-54

P1: COPPER TO FG ELBOWS



Description	Code
R-15mm to 15mm Copper	P1-ECC-15-15
R-22mm to 22mm Copper	P1-ECC-22-22
R-28mm to 28mm Copper	P1-ECC-28-28
R-35mm to 42mm Copper	P1-ECC-35-42
R-42mm to 54mm Copper	P1-ECC-42-54
R-54mm to 54mm Copper	P1-ECC-54-54

P1: REDUCING TEES



Description	Code
R-22mm x R-22mm x R-15mm	P1-TR-22-22-15
R-28mm x R-28mm x R-15mm	P1-TR-28-28-15
R-28mm x R-28mm x R-22mm	P1-TR-28-28-22
R-35mm x R-35mm x R-22mm	P1-TR-35-35-22
R-35mm x R-35mm x R-28mm	P1-TR-35-35-28
R-42mm x R-42mm x R-28mm	P1-TR-42-42-28
R-42mm x R-42mm x R-35mm	P1-TR-42-42-35
R-54mm x R-54mm x R-35mm	P1-TR-54-54-35
R-54mm x R-54mm x R-42mm	P1-TR-54-54-42

P1 BOND™ - CODE EB-01

Patented 1 step earthing terminal
Compatible with all P1 Mechanical Fittings

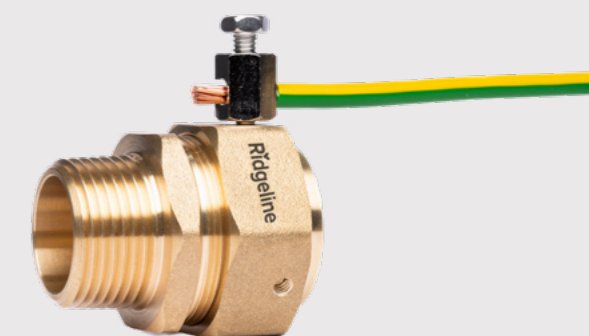

Ridgeline

☎ 01625 70 71 72

Sunnybank, Giantswood Lane,
Somerton Booths,
Cheshire, CW12 2JR

sales@RidgelineTubes.com
www.RidgelineTubes.com